

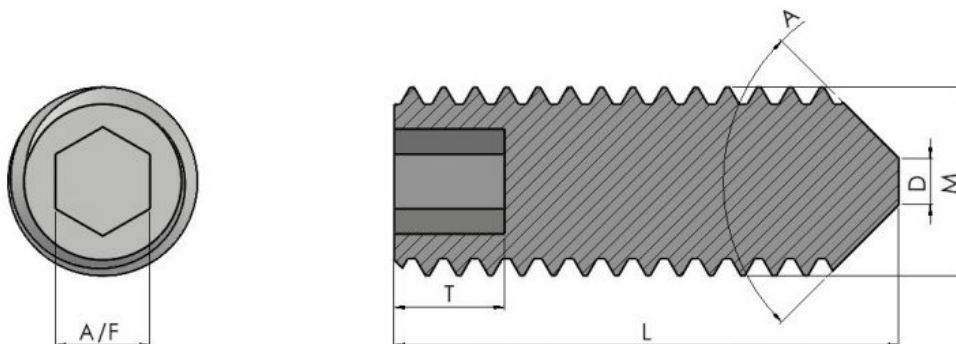

Series: 11701 CN Type: - DIN 914



Hexagon Socket Set Cone Point

Part No.	Thread	X	Y	T when L<X	T when L>Y	Angle when L<X	Angle when L>Y	A/F	D
11701 030**CN	M3	4	5	1.20	2.00	120	90	1.50	0.75
11701 040**CN	M4	5	6	1.50	2.50	120	90	2.00	1.00
11701 050**CN	M5	6	8	2.00	3.00	120	90	2.50	1.25
11701 060**CN	M6	6	8	2.00	3.50	120	90	3.00	1.50
11701 080**CN	M8	8	10	3.00	5.00	120	90	4.00	2.00
11701 100**CN	M10	10	12	4.00	6.00	120	90	5.00	2.50
11701 120**CN	M12	12	16	4.80	8.00	120	90	6.00	3.00

Legend	
*	Usually Available from Stock
**	Non-preferred (Possible Lead Times)
***	Special Order Only

Thread/Length	3	4	5	6	8	10	12	14	16	20	25	30	35	40	45	50	60
M3	*	*	*	*	*	*	*	*	*	*	*	***	***	***	***	***	***
M4	***	*	*	*	*	*	*	*	*	*	*	***	***	***	***	***	***
M5	***	***	*	*	*	*	*	***	*	*	*	*	***	***	***	***	***
M6	***	***	*	*	*	*	*	***	*	*	*	*	*	*	*	*	***
M8	***	***	***	***	*	*	*	***	*	*	*	*	*	*	*	*	***
M10	***	***	***	***	***	*	*	***	*	*	*	*	*	*	*	***	*
M12	***	***	***	***	***	***	*	***	*	*	*	*	*	*	*	*	*

Material/Finish/Finish Code:

Steel - Self Colour - 00Steel - Zinc Plated - 60Stainless Steel A2 - Self Colour - SSSStainless Steel A4 - Self Colour - A4



Continued from previous page...

Series: 11701 CN Type: - DIN 914

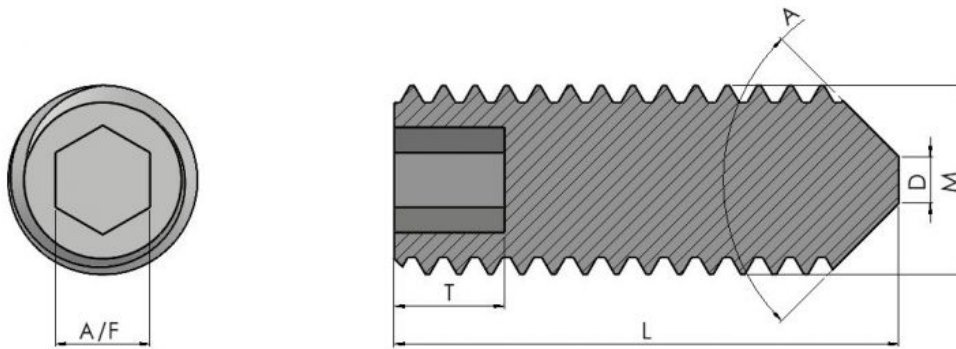

Part Number ID:

Part No/Thread Length/grade/Finish Code Eg: 11701 06016CN 60: M6 x 16 Zinc Clear

All information is given for guidance only and designers should satisfy themselves as to the suitability of the specification by requesting samples