

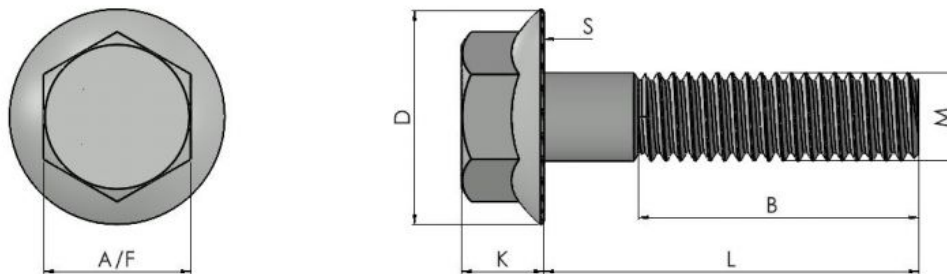

Series: 10105 Type: - DIN 6921, 8.8



Serrated Hex Flange Bolts Grade 8.8

Part No.	Thread	K	B When (L>B)	A/F	D	S
10105 FBS05**	M5	5.40	16.00	8.00	11.80	18-24
10105 FBS06**	M6	6.60	18.00	10.00	14.20	20-28
10105 FBS08**	M8	8.10	22.00	13.00	18.00	24-30
10105 FBS10**	M10	9.20	26.00	15.00	22.30	30-40
10105 FBS12**	M12	11.50	30.00	16.00	26.60	30-45

Legend	
*	Usually Available from Stock
**	Non-preferred (Possible Lead Times)
***	Special Order Only

Thread/Length	10	12	16	20	25	30	35	40	45	50
M5	*	*	*	*	*	*	***	***	***	***
M6	*	*	*	*	*	*	*	*	***	***
M8	***	*	*	*	*	*	*	*	***	***
M10	***	***	*	*	*	*	*	*	*	*
M12	***	***	***	***	*	*	*	*	*	*

Material/Finish/Finish Code:

Steel - Zinc Plated - 60

Part Number ID:

Part No/Thread Length/grade/Finish Code Eg: 10105 FBS0616 60: Flange Bolt Serrated M6 x 16 Zinc Clear 8.8

All information is given for guidance only and designers should satisfy themselves as to the suitability of the specification by requesting samples