

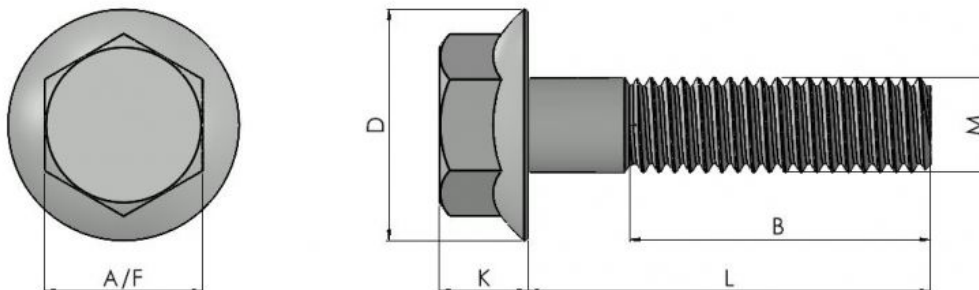

Series: 10105 Type: - DIN 6921, 8.8



Non-Serrated Hex Flange Bolts Grade 8.8

Part No.	Thread	K	B When (L>B)	A/F	D
10105 FB05**	M5	5.40	16.00	8.00	11.80
10105 FB06**	M6	6.60	18.00	10.00	14.20
10105 FB08**	M8	8.10	22.00	13.00	18.00
10105 FB10**	M10	9.20	26.00	15.00	22.30
10105 FB12**	M12	11.50	30.00	16.00	26.60
10105 FB16**	M16	14.40	38.00	21.00	35.00

Legend	
*	Usually Available from Stock
**	Non-preferred (Possible Lead Times)
***	Special Order Only

Thread/Length	10	12	16	20	25	30	35	40	45	50	60
M5	*	*	*	*	*	***	***	***	***	***	***
M6	*	*	*	*	*	*	*	*	***	***	***
M8	***	*	*	*	*	*	*	*	***	*	*
M10	***	***	*	*	*	*	*	*	*	*	*
M12	***	***	***	***	*	*	*	*	*	*	*
M16	***	***	***	***	***	***	*	*	***	*	***

Material/Finish/Finish Code:

Steel - Zinc Plated - 60

Part Number ID:

Part No/Thread Length/grade/Finish CodeEg: 10105 FB0616 60: Flange Bolt M6 x 16 Zinc



Continued from previous page...

Series: 10105 Type: - DIN 6921, 8.8

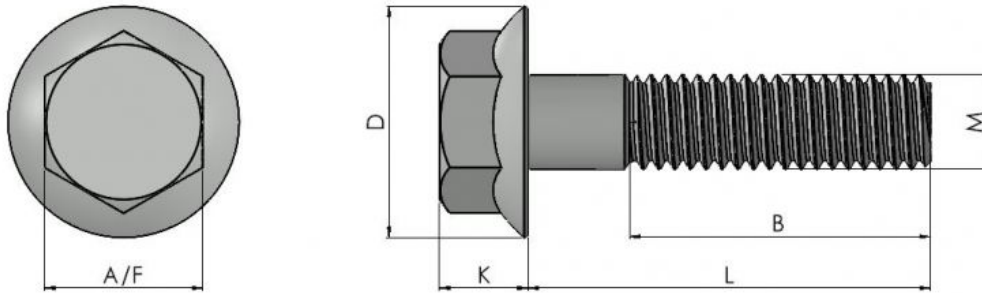

Clear 8.8

All information is given for guidance only and designers should satisfy themselves as to the suitability of the specification by requesting samples