

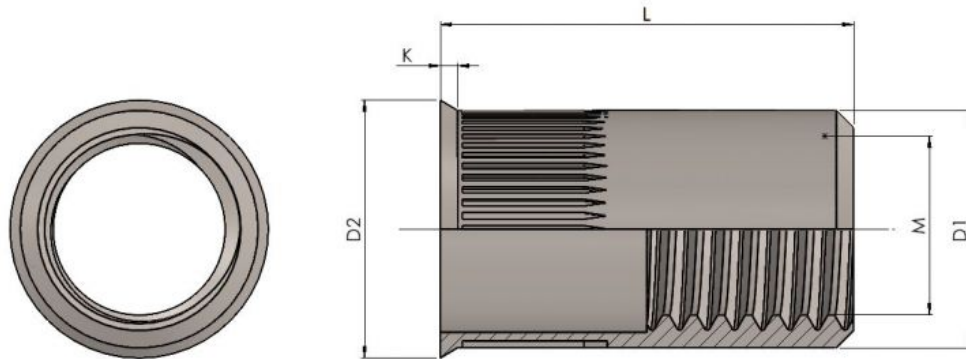

Series: 30201 Type: RRI Steel



Rivet Nut Reduced Head Round Body (Imperial Hole)

Part No	Thread M	Grip Range	Hole Size	D1	D2	K	L
RRI03	M3	0.5-1.5	4.8	4.7	5.3	0.4	9.0
RRI04	M4	0.5-2.0	6.4	6.3	7.1	0.5	10.5
RRI05	M5	0.5-3.0	7.2	7.1	9.5	0.5	12.0
RRI06	M6	0.5-3.5	6.9	9.5	10.3	0.6	15.0
RRI08	M8	0.7-3.8	10.6	10.5	11.5	0.6	16.0

Reduced Head Rivet Nuts provide a strong reliable fixing with an almost flush low profile head. The serrated body offers high resistance to torque especially in softer materials.
Materials and Finishes (Code):
Steel, Trivalent Zinc (60)

All information is given for guidance only and designers should satisfy themselves as to the suitability of the specification by requesting samples