

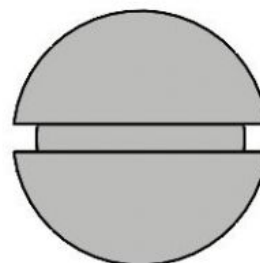

Series: 10601 Type: - DIN 963

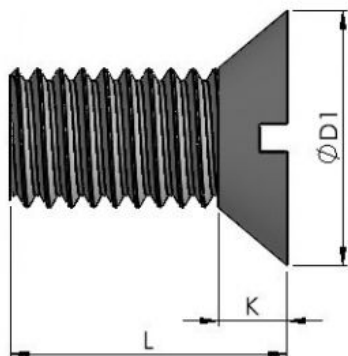

## Slotted Countersunk Head

Part No.	Thread	D1	K
10601 M3**	M3	5.60	1.65
10601 M4**	M4	7.50	2.20
10601 M5**	M5	9.20	2.50
10601 M6**	M6	11.00	3.00
10601 M8**	M8	14.50	4.00
10601 M10**	M10	18.00	5.00

Legend	
*	Usually Available from Stock
**	Non-preferred (Possible Lead Times)
***	Special Order Only

Thread/Length	6	8	10	12	16	20	25	30	35	40	45	50	55	60
M3	*	***	*	***	*	***	***	***	***	***	***	***	***	***
M4	***	***	*	*	*	*	*	*	***	*	***	***	***	***
M5	***	***	*	*	*	*	*	*	***	***	***	***	***	***
M6	***	***	***	*	*	*	*	*	***	***	***	***	***	***
M8	***	***	***	***	***	*	*	*	***	*	***	*	***	*
M10	***	***	***	***	***	*	***	***	*	***	***	*	***	***

Machine Screws are round bodied, metric threaded fasteners that can be used either with a nut or with a pre-tapped hole in metal applications.  
Material/Finish/Code:

**All information is given for guidance only and designers should satisfy themselves as to the suitability of the specification by requesting samples**



Continued from previous page...

Series: 10601 Type: - DIN 963

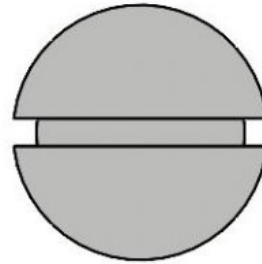
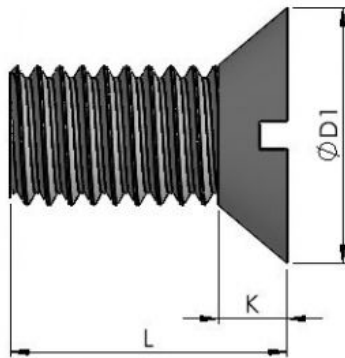

### Slotted Countersunk Head

Steel - Zinc Clear - 60Stainless Steel A2 - Self Colour - SSStainless Steel A4 -Self Colour - A4  
To get the part number replace \*\* with the length found in the tables below followed by the finish code:

---

All information is given for guidance only and designers should satisfy themselves as to the suitability of the specification by requesting samples