

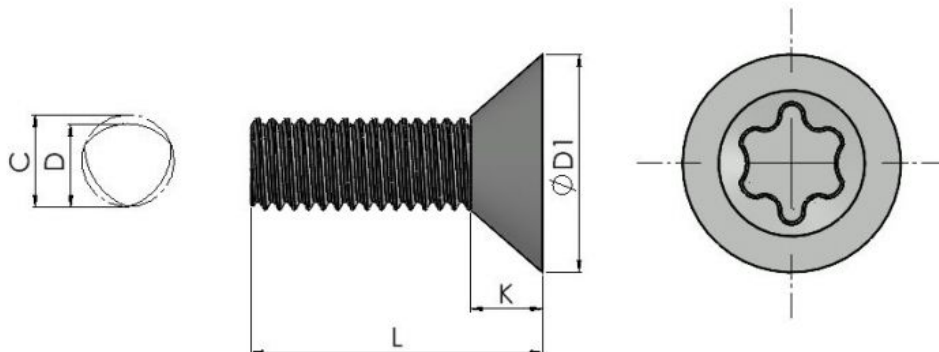

Series: 11511 Type: - DIN 7500M TX



## Tap-Tight Torx Countersunk Head

Part No.	Thread	D1	K	C	Recess
11511 M2**	M2	3.80	1.20	2.06	T6
11511 M2.5**	M2.5	4.70	1.50	2.57	T8
11511 M3**	M3	5.60	1.65	3.07	T10
11511 M3.5**	M3.5	6.50	1.93	3.58	T15
11511 M4**	M4	7.50	2.20	4.08	T20
11511 M5**	M5	9.20	2.50	5.09	T25
11511 M6**	M6	11.00	3.00	6.10	T30
11511 M8**	M8	14.50	4.00	8.13	T40

Legend	
*	Usually Available from Stock
**	Non-preferred (Possible Lead Times)
***	Special Order Only

Thread / Length	4	5	6	8	10	12	14	16	18	20	25	30	35	40	45	50
M2	***	***	*	***	***	***	***	***	***	***	***	***	***	***	***	***
M2.5	***	***	*	*	*	***	***	***	***	***	***	***	***	***	***	***
M3	*	*	*	*	*	*	***	***	***	***	*	*	***	***	***	***
M3.5	***	***	***	*	***	***	***	***	***	***	***	***	***	***	***	***
M4	***	***	*	*	*	*	***	*	***	*	*	*	*	***	***	***
M5	***	***	***	*	*	*	***	*	***	*	*	*	***	***	***	***
M6	***	***	***	***	*	*	***	*	***	*	*	*	***	*	***	*
M8	***	***	***	***	***	***	***	***	*	*	*	*	***	*	***	*



**Continued from previous page...**

Series: 11511 Type: - DIN 7500M TX

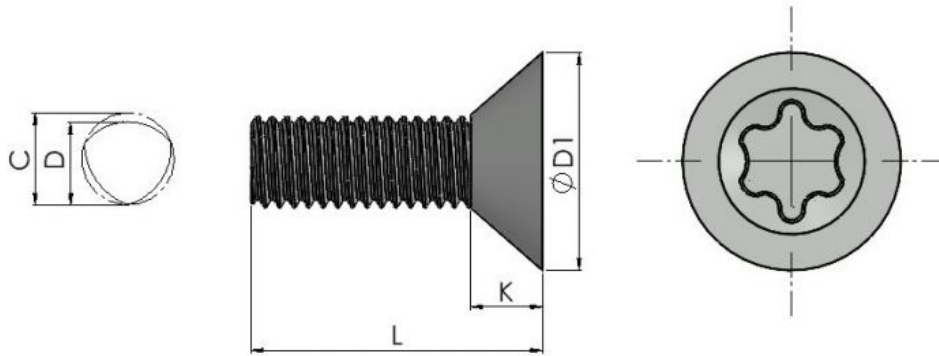

### **Tap-Tight Torx Countersunk Head**

Thread forming screws have a trilobular thread form. These require a low level of assembly torque to initiate thread forming in sheet metal, castings and alloys. Further benefits: Screws form a female thread capable of accepting a standard metric machine screw should the need arise. The three lobed thread design allows the displaced parent material to cold flow into the relief areas of the screw thereby increasing the resistance to vibration and loosening of the screw.

Material: Steel Finish: Zinc Plated

For the part number replace \*\* with the desired length found in the tables below:

---

**All information is given for guidance only and designers should satisfy themselves as to the suitability of the specification by requesting samples**