

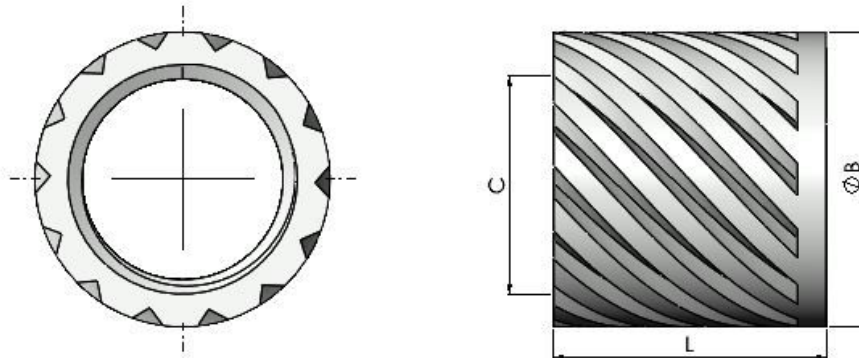

Series: 20117 Type: HPI



## Hardened Press-In Inserts

Part No.	Thread M	Dim B	Dim C	Dim L (Max)	Rec. Hole size
HPI030H045	M3	5.3	4.8	4.5	4.8
HPI040H069	M4	7.7	7.1	6.9	7.2
HPI050H069	M5	7.7	7.1	6.9	7.2
HPI060H095	M6	10.3	9.5	9.5	9.6

Series 20117 Type HPI Inserts, offer very hard wearing threads in lighter alloys, preventing the stripping of threads where multiple installation / removal of the mating screw is likely. They are also suitable for repairing damaged threads in alloys and castings.. There is no requirement for pre-tapped holes, they simply press into a pre-drilled hole using a toggle or fly press.

**All information is given for guidance only and designers should satisfy themselves as to the suitability of the specification by requesting samples**