

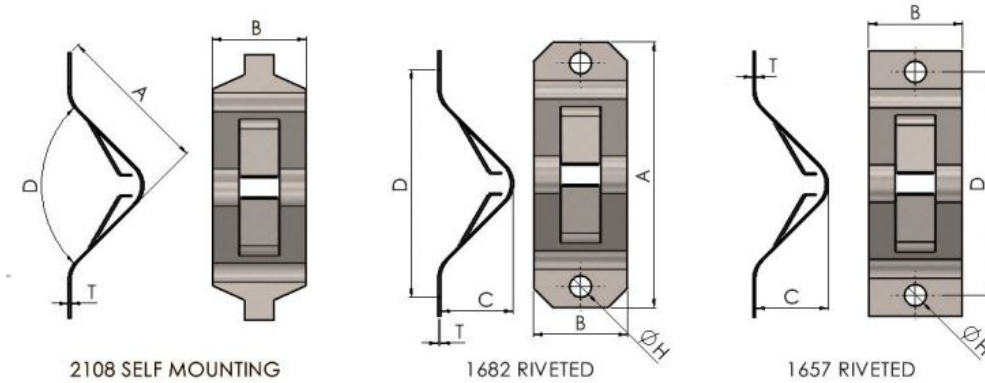

Series: 40201 Type: SL



## Latch Clips

Part No.	Approx Pull off	MatingPart	Dim A	Dim B	Dim C	Dim D	Dim H	Dim T
1682	6.4Kg	3847 / 3848	25.4	11.2	6.8	19.0	3.35	0.46
2108	9.1Kg	3849 / 2141 / 3850	18.0	16.0	3.0	40 deg	9.52	0.56
1657	5.0Kg	3845 / 3846	50.5	17.5	15.7	38.1	3.33	0.51

SL Spring Latch Clips provide a very convenient way of fastening any detachable service hatch or door into position or even used purely as a door latch in thin sheet metal products. There are various shapes and sizes to offer the designer the choice of pullout loads. Parts 2108 & 2130 are self mounting without the need for riveting. For information on mating studs see our 40301 series. Material: Spring Steel Finish: Oiled or Trivalent Zinc

**All information is given for guidance only and designers should satisfy themselves as to the suitability of the specification by requesting samples**