

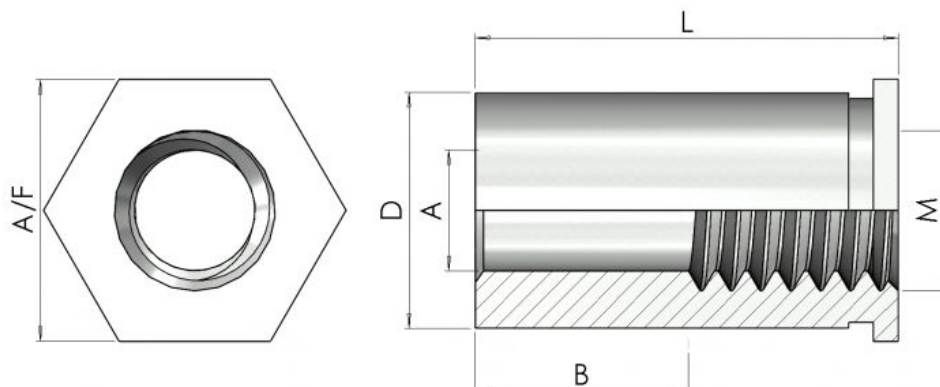

Series: 30314 Type: COM



Self Clinch Through Stand Off

Part No.	Thread M	Sheet Min E	Body Diam. D	Head A/F H	Hole Size	Bore A	Length P	X Min.
02COM	M2	1.0	4.18	4.8	4.20	3.2	0-4	6.0
02.5COM	M2.5	1.0	4.18	4.8	4.20	3.2	0-4	6.0
03COM	M3	1.0	4.18	4.8	4.20	3.2	0-4	6.0
03COML	M3	1.0	5.39	6.4	5.40	4.0	0-4	7.0
04COM	M4	1.3	7.10	7.9	7.14	4.8	0-4	8.0
05COM	M5	1.3	7.10	7.9	7.14	5.2	8-12	8.0

Legend	
*	Usually Available from Stock
**	Non-preferred (Possible Lead Times)
***	Special Order Only

Part	3	4	5	6	8	10	12	14	15	16	18	20	22	25
02COM	*	*	*	*	**	**	**	**	**	**	**	**	**	**
02.5COM	**	*	*	*	*	*	*	**	**	**	**	**	**	**
03COM	*	*	*	*	*	*	*	*	*	*	*	*	**	**
03COML	**	*	*	*	*	*	*	*	*	*	*	*	*	*
04COM	*	*	*	*	*	*	*	*	*	*	*	*	*	*
05COM	**	**	**	*	*	*	*	*	*	*	*	*	*	*



Continued from previous page...

Series: 30314 Type: COM

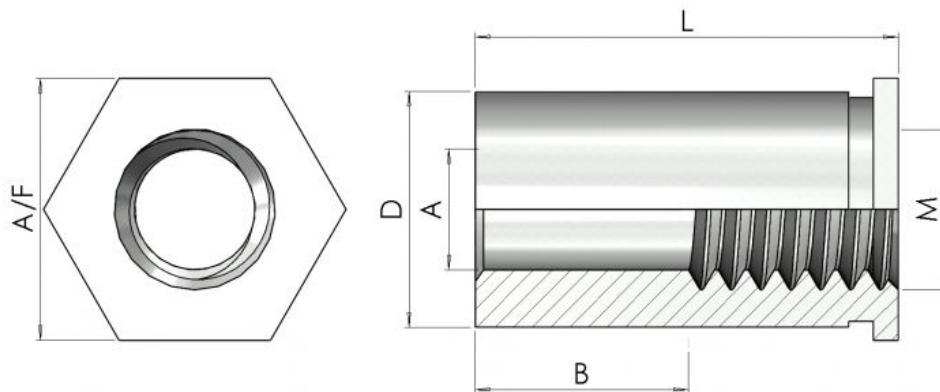

Self Clinch Through Stand Off

Self Clinch Through Standoffs provide a strong female thread in sheet metal. They are designed to provide a flush finish on the reverse side and are available in various lengths to allow components to be mounted at the required stand off distance from the sheet. They are installed using a squeezing action with a press whilst supporting the reverse side. The through hole allows screws to be mounted from both sides. Materials & Finishes:-Heat Treated Carbon Steel Trivalent Zinc (Code 60)303 Stainless Steel Self Colour (Cose SS)

To Specify use Series No / Part No / Length / Finish Code eg 30314 03COM10 60

Available Lengths

All information is given for guidance only and designers should satisfy themselves as to the suitability of the specification by requesting samples