

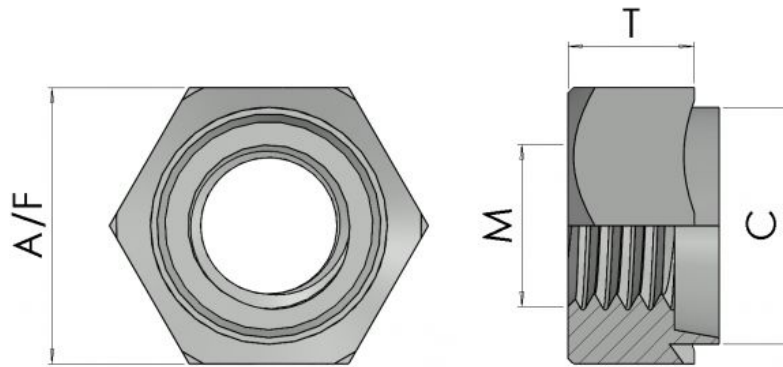

Series: 30108 Type: HEX



Hexagon Rivet Bushes

| Part No. | Thread | Hole Size+0.5-0 | A/F E +/- 0.13 | Body T+/-0.13 | Skirt C/+0-0.13 |
|----------|--------|-----------------|----------------|---------------|-----------------|
| M25??HEX | M2.5 | 5.54 | 7.92 | 3.17 | 5.54 |
| M3??HEX | M3 | 5.54 | 7.92 | 3.17 | 5.54 |
| M35??HEX | M3.5 | 6.73 | 7.92 | 3.17 | 6.73 |
| M4??HEX | M4 | 6.73 | 7.92 | 3.17 | 6.73 |
| M5??HEX | M5 | 7.92 | 9.52 | 3.81 | 7.92 |
| M6??HEX | M6 | 9.52 | 11.10 | 5.08 | 9.52 |
| M8??HEX | M8 | 12.70 | 14.27 | 6.35 | 12.70 |
| M10??HEX | M10 | 15.87 | 19.05 | 7.62 | 15.87 |
| M12??HEX | M12 | 19.05 | 22.22 | 10.16 | 19.05 |

| Legend | |
|--------|-------------------------------------|
| * | Usually Available from Stock |
| ** | Non-preferred (Possible Lead Times) |
| *** | Special Order Only |

| SWG/MM | M2.5 | M3 | M3.5 | M4 | M5 | M6 | M8 | M10 | M12 |
|---------|------|-----|------|-----|-----|-----|-----|-----|-----|
| 8G/4.0 | *** | *** | *** | *** | *** | *** | *** | ** | ** |
| 10G/3.2 | *** | ** | ** | ** | ** | * | * | * | * |
| 12G/2.5 | *** | ** | ** | ** | * | * | * | * | * |
| 14G/2.0 | *** | * | ** | * | * | * | * | * | * |
| 16G/1.6 | * | * | ** | * | * | * | * | ** | ** |
| 18G/1.2 | *** | * | ** | * | * | * | * | ** | *** |



Continued from previous page...

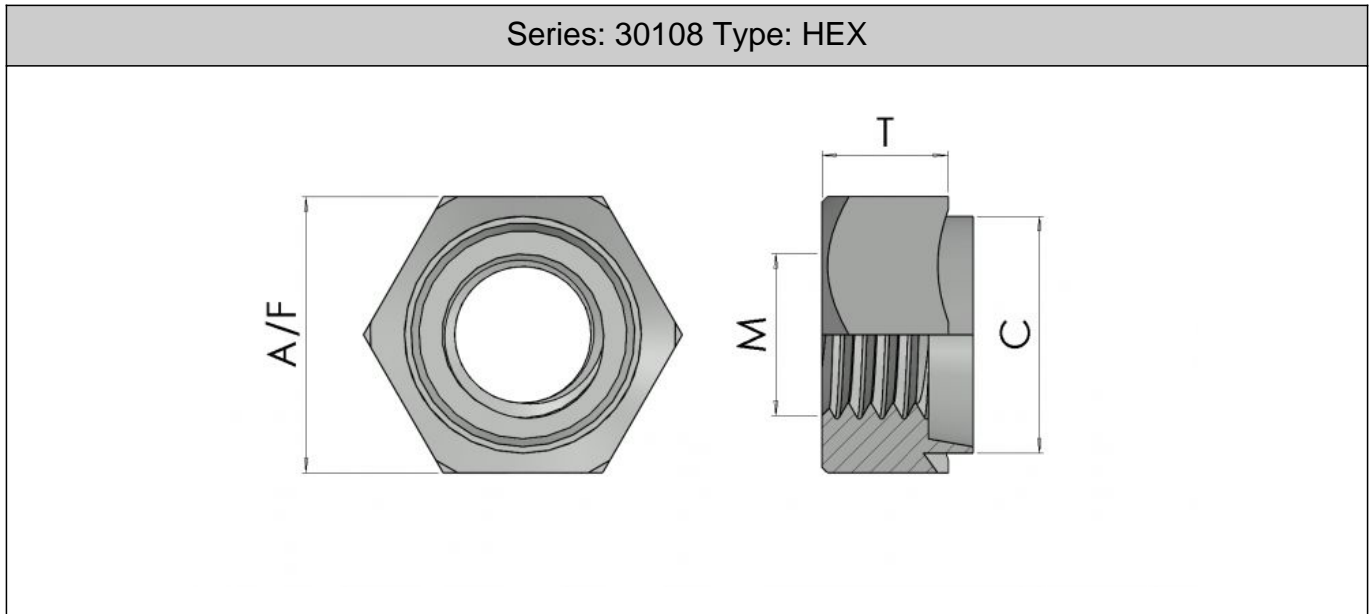

| | | | | | | | | | |
|---------|-----|---|----|---|---|----|----|-----|-----|
| 20G/1.0 | *** | * | ** | * | * | ** | ** | *** | *** |
|---------|-----|---|----|---|---|----|----|-----|-----|

Hexagon Rivet Bushes provide a strong female thread in sheet metal. The spigot is placed through a pre-punched hole and riveted on the reverse side, the corners of the hex bar bite into the sheet providing excellent torque resistance. Various spigot lengths are available for different sheet thicknesses.

Materials & Finishes:-Steel Solf Colour (Code 2)Steel Trivalent Zinc (Code 26)303 Stainless Steel (Code SS)

To Specify Use Serie No / Part No / Material Size / Finish Code (eg 30108 M416 HEX26)

Prefered Sizes

All information is given for guidance only and designers should satisfy themselves as to the suitability of the specification by requesting samples