

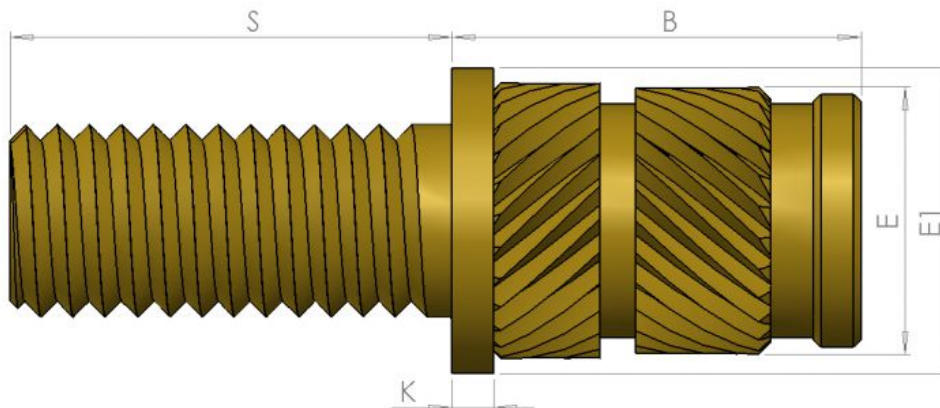

Series: 20106 Type: HSS



Heatstake / Ultrasonic Headed Stud

Part No.	Thread A	Ext. Diam. E	Head dia. E1	Head thic kn K	Insert length B	Stud length S	Hole dia. L+0.1	Min Wall W
HSS020L_	M2.0	3.60	4.80	0.60	4.60	6-16	3.2	2.0
HSS025L_	M2.5	4.60	5.60	0.60	6.40	6-16	4.0	2.3
HSS030L_	M3.0	4.60	5.60	0.60	6.40	6-16	4.0	2.3
HSS035L_	M3.5	5.40	6.40	0.80	8.00	6-25	4.8	2.5
HSS040L_	M4.0	6.30	7.20	0.80	9.00	6-25	5.6	2.5
HSS050L_	M5.0	7.00	8.00	1.00	10.50	6-25	6.4	2.7
HSS060L_	M6.0	8.60	9.50	1.30	14.00	6-25	8.0	3.0
HSS080L_	M8.0	10.20	11.00	1.30	14.00	10-25	9.6	3.5

The HSS Insonic Range of Inserts have the same features as the HS range but with a male thread. They can be installed with ultrasonic or heat insertion machines in all thermo plastics. The unique opposing helix knurl provides exceptional resistance to torque loads and facilitates the flow of plastic into the two recessed grooves providing greater pullout loads than alternative designs. Materials and Finishes: Brass Self Colour (nickel plated on request) 303 Stainless Steel (code S) special order only check with sales dept. To Specify Use: Series No / Part No / Length (eg 20106 HSS050L15 M5x15 long stud)

All information is given for guidance only and designers should satisfy themselves as to the suitability of the specification by requesting samples