

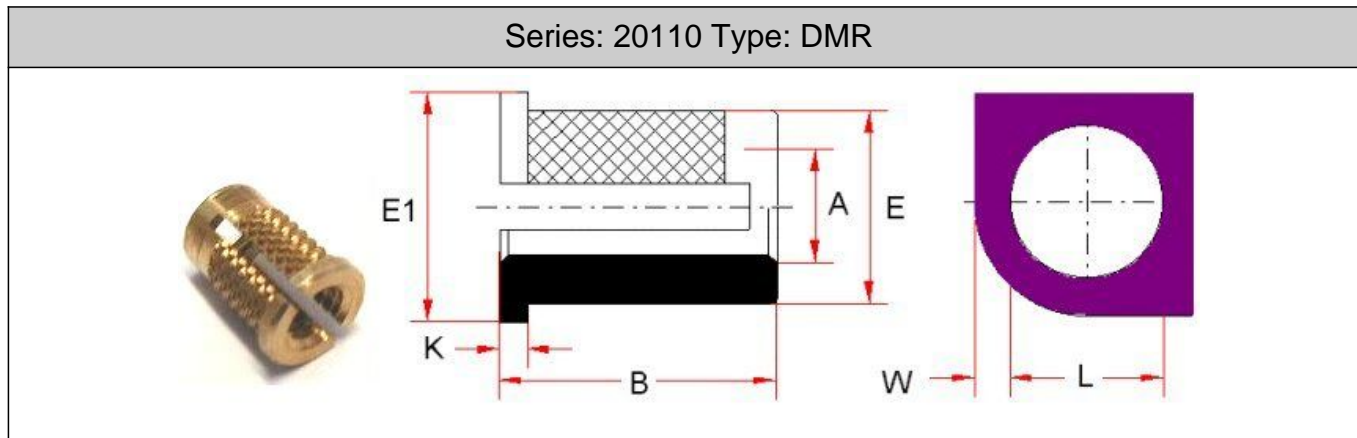

Series: 20110 Type: DMR



Reverse Headed Expansion Insert

Part No.	Thread A	Ext. Diam. E	Length B	Head Dia.. E1	Head Length K	Min wall W	Hole Diam L
DMR020H040	M2.0	3.45	4.00	4.80	0.60	2.40	3.2 - 3.3
DMR025H048	M2.5	4.20	4.80	5.60	0.60	2.80	4.0 - 4.1
DMR030H048	M3.0	4.20	4.80	5.60	0.60	3.20	4.0 - 4.1
DMR035H064	M3.5	5.00	6.40	6.40	0.80	3.60	4.7 - 4.8
DMR040H080	M4.0	5.85	8.00	7.20	0.80	4.00	5.5 - 5.6
DMR050H095	M5.0	6.60	9.50	8.00	1.00	4.80	6.3 - 6.4
DMR060H127	M6.0	8.30	12.70	9.50	1.30	6.00	7.9 - 8.0
DMR080H127	M8.0	9.90	12.70	11.00	1.30	6.00	9.5 - 9.6

DMR Series Inserts are designed to provide strong reusable threads in thermoset and other hard plastics. On installation, the insert collapses as it is pushed into the receiving hole. Insertion of the screw expands the sharp diamond points of the knurl into the surface of the hole and penetrates the plastic. This provides a high resistance to torque and pullout loads. The DMR has a slot through the head. The screw is meant to enter the insert from the opposite side to the head. The head therefore gives additional resistance to pull-through loads. Material and Finish: Brass Self Colour To Specify Use: Series No / Part No (eg 20110 DMR050H095)

All information is given for guidance only and designers should satisfy themselves as to the suitability of the specification by requesting samples