

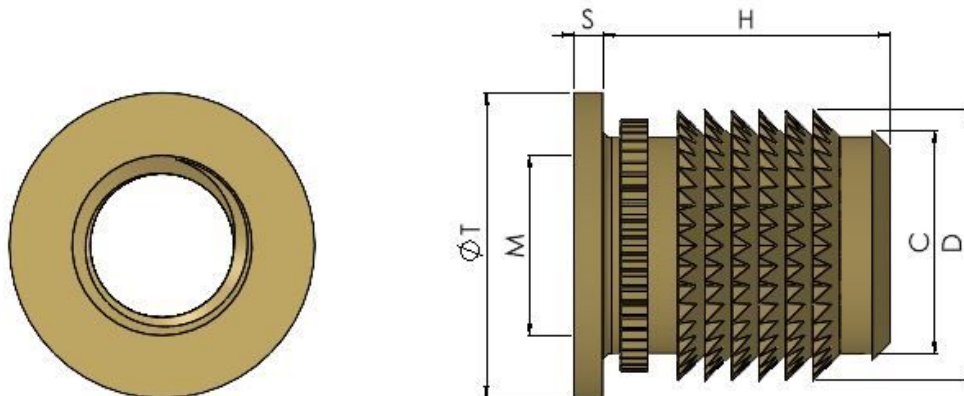

Series: 20103 Type: THC



Heatstake / Press In Headed Insert

Part No.	Size M	Dim H	Body Diam D	Lead Diam C	Head Diam T	Head Depth S	Hole Diam d-0.1	Hole Depth P	Min Wall E	L Dia	Depth G+0.1
THC025H050	M2.5	5.0	4.0	3.5	5.5	0.5	3.6	6.5	1.0	5.6	0.5
THC030H055	M3	5.5	4.5	3.9	6.0	0.5	4.1	7.0	1.1	6.1	0.5
THC035H060	M3.5	6.0	5.5	4.7	7.0	0.5	5.1	7.5	1.3	7.1	0.5
THC040H075	M4	7.5	6.0	5.4	7.5	0.8	5.5	9.0	1.4	7.6	0.8
THC050H080	M5	8.0	7.0	6.4	8.5	0.8	6.5	9.5	1.7	8.6	0.8
THC060H090	M6	9.0	8.5	7.9	10.5	0.8	8.0	11.0	2.0	10.	0.8
THC080H100	M8	10.0	10.0	9.4	12.0	1.0	9.5	13.0	2.4	12.	1.0
THC100H130	M10	13.0	12.0	11.2	14.0	1.0	11.4	15.5	2.9	14.	1.0

TH inserts are recommended for thermoplastic applications. Their geometric shape and sharp pointed barbs ensure swift installation and complete flow of material to encapsulate the insert, providing ultimate resistance to torque loading and maximum tensile strength. The head provides a larger clamping surface to prevent jack out. Material and Finishes: Brass Self Colour To Specify Use Series No / Part No (eg 20103 THC030H055)

All information is given for guidance only and designers should satisfy themselves as to the suitability of the specification by requesting samples