

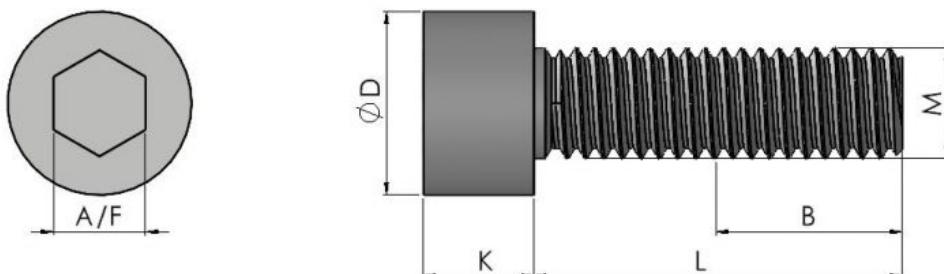

Series: 11702 Type: - DIN 912



Hexagon Socket Cap Head 8.8

| Part No. | Thread | K | B if L longer than B | D | A/F |
|-------------|--------|-------|----------------------|-------|-------|
| 11702 M03** | M3 | 3.00 | 18.00 | 5.50 | 2.50 |
| 11702 M04** | M4 | 4.00 | 20.00 | 7.00 | 3.00 |
| 11702 M05** | M5 | 5.00 | 22.00 | 8.50 | 4.00 |
| 11702 M06** | M6 | 6.00 | 24.00 | 10.00 | 5.00 |
| 11702 M08** | M8 | 8.00 | 28.00 | 13.00 | 6.00 |
| 11702 M10** | M10 | 10.00 | 32.00 | 16.00 | 8.00 |
| 11702 M12** | M12 | 12.00 | 36.00 | 18.00 | 10.00 |
| 11702 M16** | M16 | 16.00 | 44.00 | 24.00 | 14.00 |
| 11702 M20** | M20 | 20.00 | 52.00 | 30.00 | 17.00 |
| 11702 M24** | M24 | 24.00 | 60.00 | 36.00 | 19.00 |

| | Legend |
|-----|-------------------------------------|
| * | Usually Available from Stock |
| ** | Non-preferred (Possible Lead Times) |
| *** | Special Order Only |

[illegible]

All information is given for guidance only and designers should satisfy themselves as to the suitability of the specification by requesting samples



Continued from previous page...

Series: 11702 Type: - DIN 912

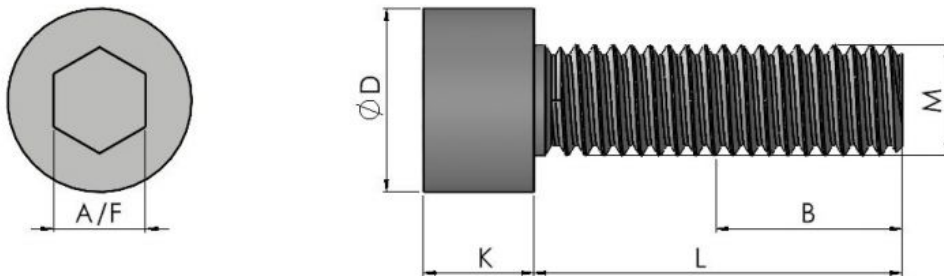

*





Continued from previous page...

Series: 11702 Type: - DIN 912

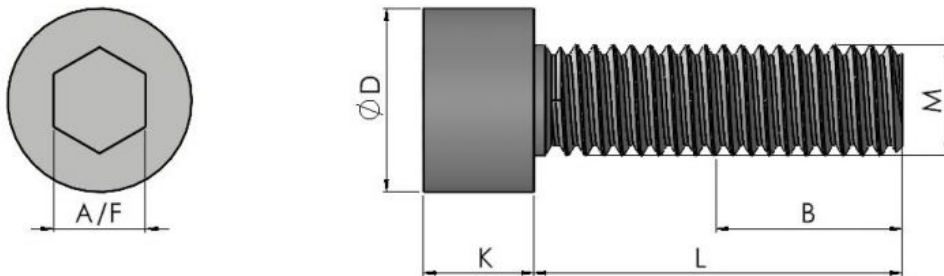

*





Continued from previous page...

Series: 11702 Type: - DIN 912

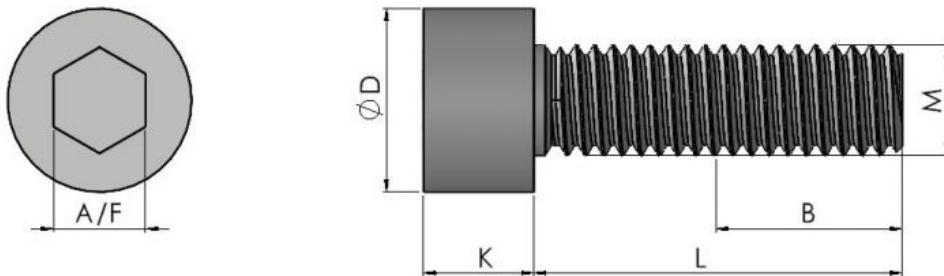

*





Continued from previous page...

Series: 11702 Type: - DIN 912

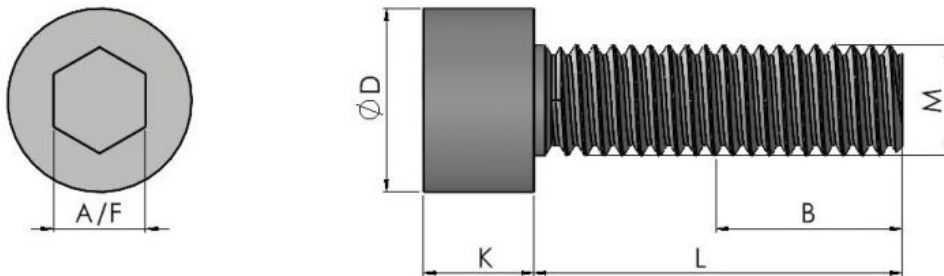

*





Continued from previous page...

Series: 11702 Type: - DIN 912

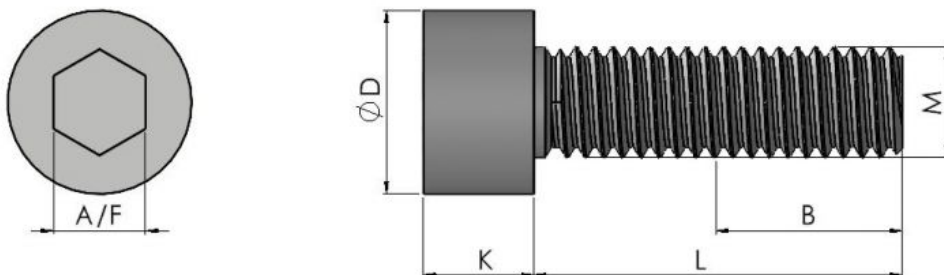

*





Continued from previous page...

Series: 11702 Type: - DIN 912

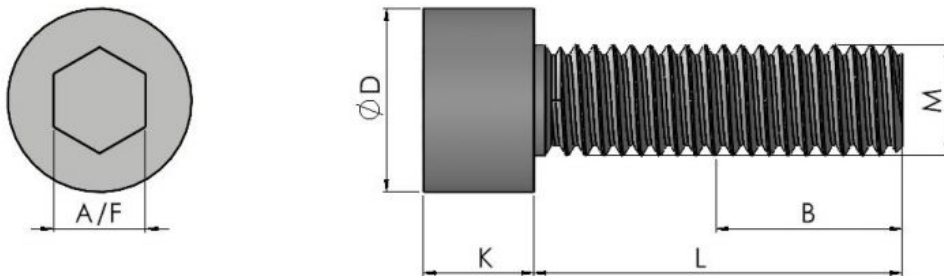

*





Continued from previous page...

Series: 11702 Type: - DIN 912

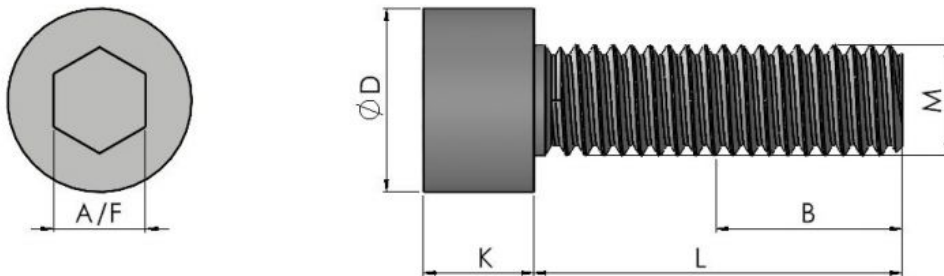

*





Continued from previous page...

Series: 11702 Type: - DIN 912

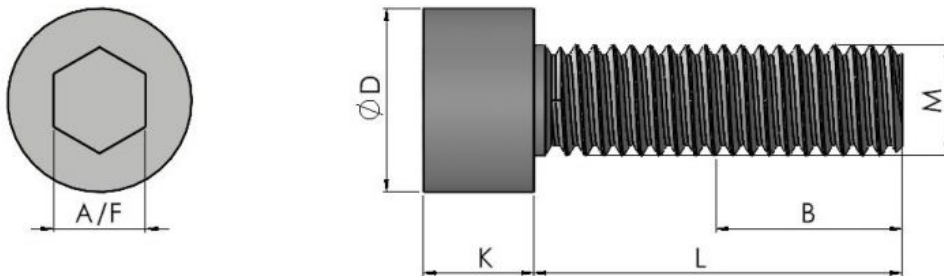

*





Continued from previous page...

Series: 11702 Type: - DIN 912

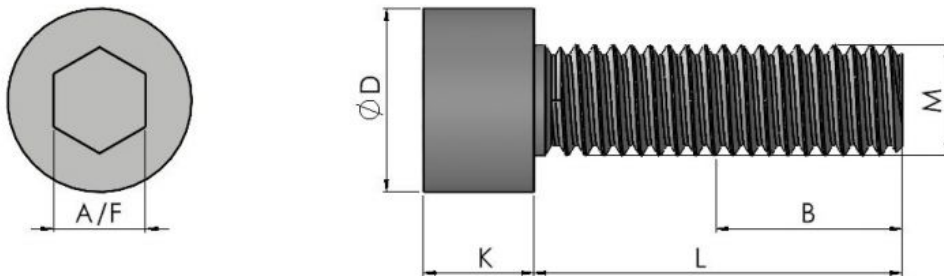

*





Continued from previous page...

Series: 11702 Type: - DIN 912

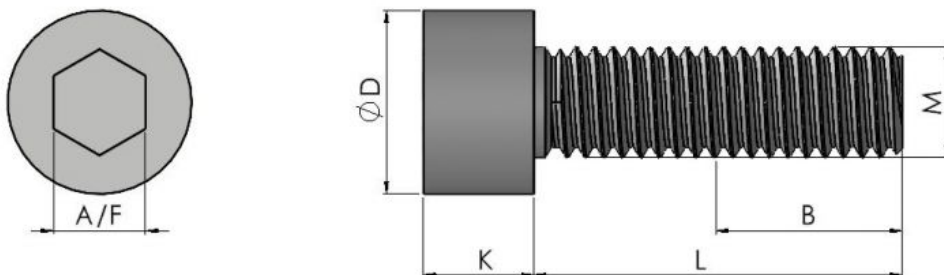

*





Continued from previous page...

Series: 11702 Type: - DIN 912

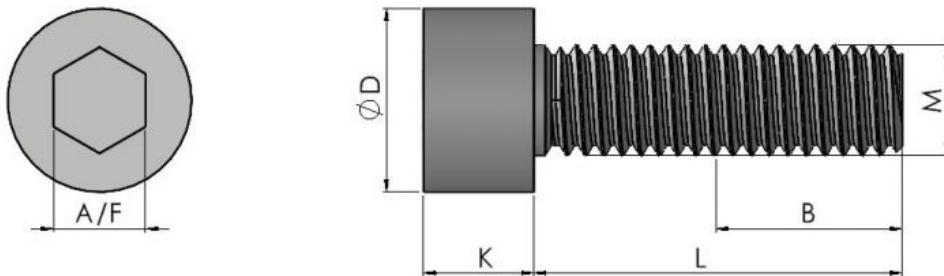

*





Continued from previous page...

Series: 11702 Type: - DIN 912

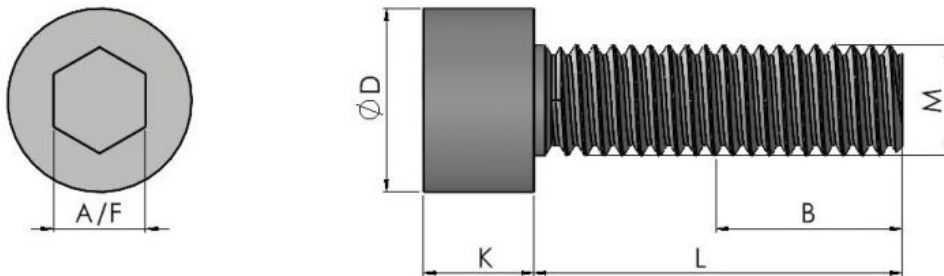

*





Continued from previous page...

Series: 11702 Type: - DIN 912

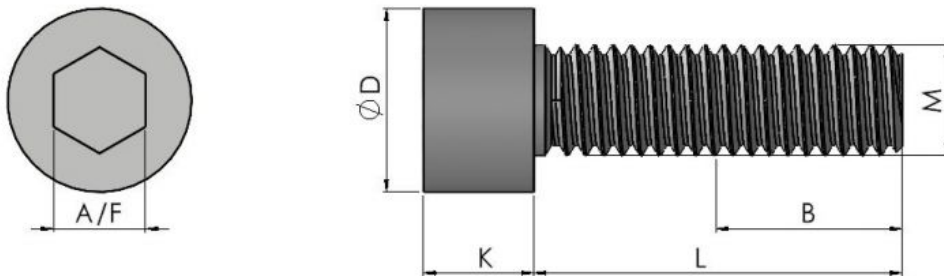

*

| | | | |
|---|---|---|----|
| * | * | * | ** |
|---|---|---|----|



Continued from previous page...

Series: 11702 Type: - DIN 912

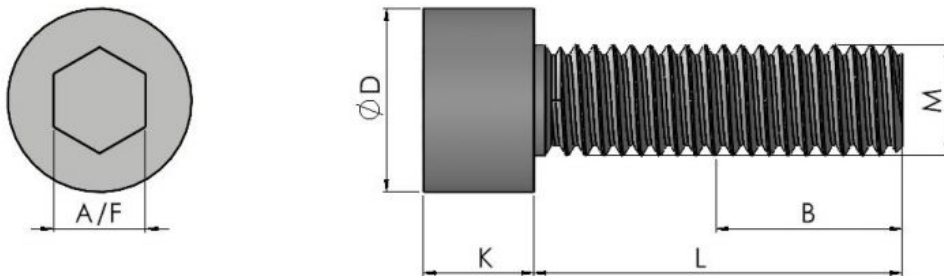

*





Continued from previous page...

Series: 11702 Type: - DIN 912

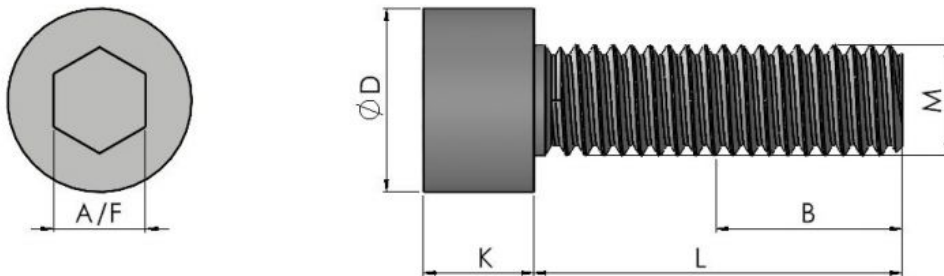

*





Continued from previous page...

Series: 11702 Type: - DIN 912

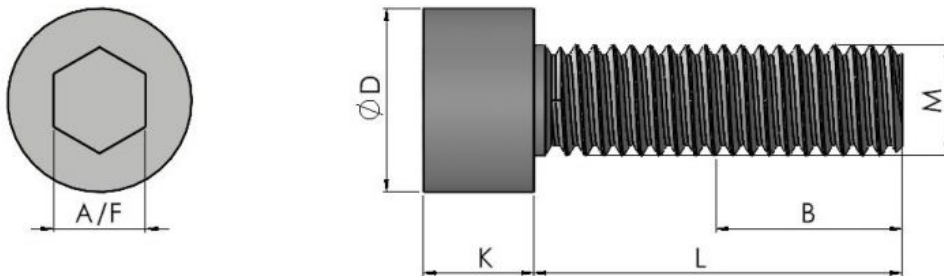

*





Continued from previous page...

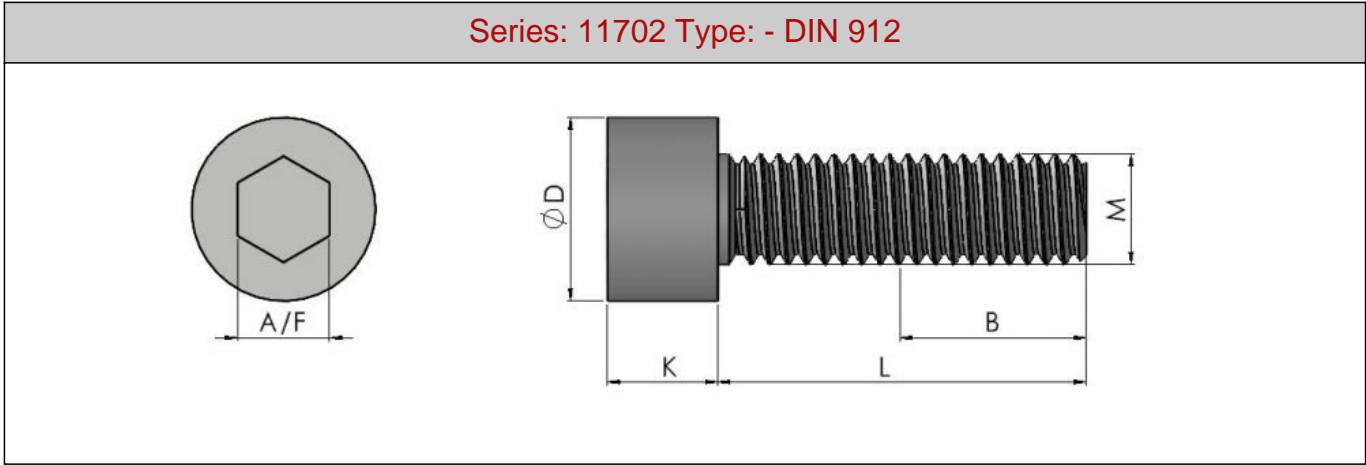

*

| | | | | | | | | |
|---|---|---|---|---|-----|-----|-----|-----|
| * | * | * | * | * | *** | *** | *** | *** |
|---|---|---|---|---|-----|-----|-----|-----|



Continued from previous page...

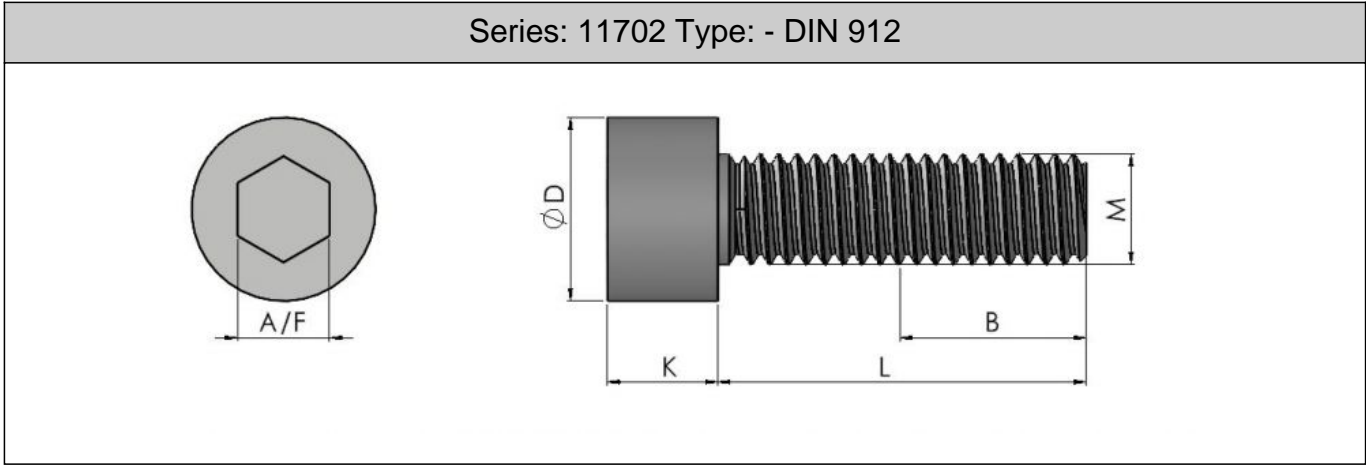

| | | | | | | | | | | | | | | | | | | | | | | | | | | | | | | | |
|-----|----|----|----|----|----|----|----|----|----|----|----|----|----|----|---|---|---|---|---|----|---|----|---|---|-----|---|-----|---|-----|-----|-----|
| M24 | ** | ** | ** | ** | ** | ** | ** | ** | ** | ** | ** | ** | ** | ** | * | * | * | * | * | ** | * | ** | * | * | *** | * | *** | * | *** | *** | *** |
| | * | * | * | * | * | * | * | * | * | * | * | * | * | * | | | | | | * | * | | | | | | | | | | |

Material/Finish/Finish Code:
Steel - Self Colour - 00Steel - Zinc Plated - 60Stainless Steel A2 - Self Colour - SSStainless
Steel A4 - Self Colour - A4
Part Number ID:
Part No/Thread Length/grade/Finish CodeEg: 11702 M0616 60: M6 x 16 Zinc Clear 8.8

All information is given for guidance only and designers should satisfy themselves as to the suitability of
the specification by requesting samples