

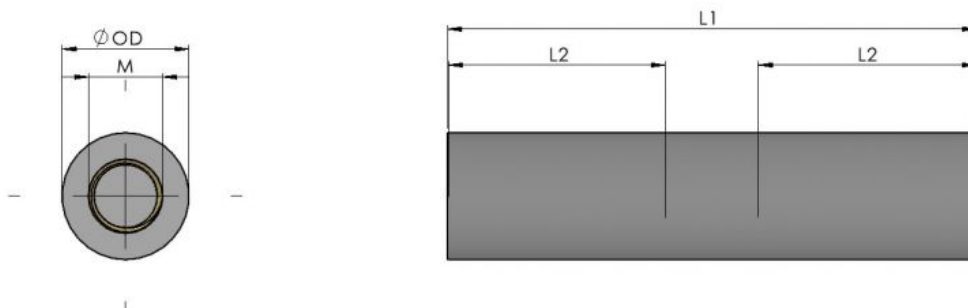

Series: 51605 Type: AS



## Acetal Spacers Blind Type

| Part No. | Thread | Body O/D | Length 1 | Length 2 |
|----------|--------|----------|----------|----------|
| 3060 25  | M3     | 6        | 25       | 10       |
| 3060 30  | M3     | 6        | 30       | 10       |
| 3060 35  | M3     | 6        | 35       | 10       |
| 3060 40  | M3     | 6        | 40       | 10       |
| 3060 45  | M3     | 6        | 45       | 10       |
| 3060 50  | M3     | 6        | 50       | 10       |
| 3060 60  | M3     | 6        | 60       | 10       |
| 4080 25  | M4     | 8        | 25       | 10       |
| 4080 30  | M4     | 8        | 30       | 10       |
| 4080 35  | M4     | 8        | 35       | 10       |
| 4080 40  | M4     | 8        | 40       | 10       |
| 4080 45  | M4     | 8        | 45       | 10       |
| 4080 50  | M4     | 8        | 50       | 10       |
| 4080 60  | M4     | 8        | 60       | 10       |

Acetal spacers are round bodied natural coloured threaded spacers available in M3 and M4 in various lengths. The shorter ones are through threaded, the longer ones blind. Service temperatures are from -40C to +100C. Material & Colour: -Acetal / Brass White To Specify Use: Series No / Part No (eg 51605 4080 25)

**All information is given for guidance only and designers should satisfy themselves as to the suitability of the specification by requesting samples**